



SCAFFAST®

The frame type scaffold SCAFFAST 75/100 by TMS complies with BS EN 12810, as well as BS EN 12811. The standard model SCAFFAST 75/100 scaffold can be used as a work scaffold within the load category 3 per BS EN 12811 (200 kg/m²). The erection height for the standard model is 24.5 m. For scaffolds higher than 24.5 m a static calculation could be supplied, if necessary. Mobile scaffold and platforms could also be erected by using the SCAFFAST 75/100 system components.

The most important product feature for SCAFFAST 75/100 scaffolding is the innovative design details providing the highest possible safe erection conditions for users. SCAFFAST 75/100 ensures to erect the both handrails, toe-guards and platforms from the lower platform level. So that, a safely workable platform complete with side protection prior to begin working on the upper level has been provided. Hence, there is no need for special erection instruments and the possible risk of failing in safety harness applications has been considerably reduced. Having four different bay lengths, ranging from 1.25 to 2.5 m, the SCAFFAST 75/100 scaffold system is very flexible. The scaffold width from axis to axis is 0.75m and 1.00m respectively for SCAFFAST 75 and SCAFFAST 100. By the use of scaffold brackets, the scaffold width can be increased and adjusted to meet different requirements for specific applications. All steel components are hot-dip galvanized and/or powder coated while all timber items are weather treated, ensuring a long life together with high safety standards. Many components and accessories are common with SCAFFAST 75/100 and other TMS scaffolds.

It is strictly suggested to keep this instruction manual available on job-sites where SCAFFAST 75/100 scaffolds are being used and to be studied thoroughly before erection. Only qualified and/or certified personnel, who is familiar to the SCAFFAST 75/100 erection manual may assemble, modify, dismantle and use the scaffold.



Swivel Coupler
(Forged)



Right Angle Coupler



Table 1 - Width classes for working areas

Width class	W (EN 12811-1) in m	Width as Measured	Conforming	Non Conforming
W 06	$0,6 \leq w < 0,90$	0,6m	✓	

Table 2 - Headroom classes

Height Class	Between working areas (EN 12811-1)	Height as Measured	Conforming	Non Conforming
H2	$h1a \geq 1,90$ m	1,99m	✓	
	$h1b \geq 1,90$ m	1,90m	✓	
	$h2 \geq 1,75$ m	1,76m	✓	
	$h3 \geq 1,90$ m	1,94m	✓	

Table 3 - Dimensions for vertical side protection with one intermediate guardrail (Ref. Figure 3)

Height Class	Dimensions for vertical side protection (EN 12811-1)	Dimensions as Measured	Conforming	Non Conforming
a	1m	1m	✓	
b	≤ 470 mm	390mm	✓	
c	≤ 470 mm	400mm	✓	
d	≤ 150 mm	150mm	✓	

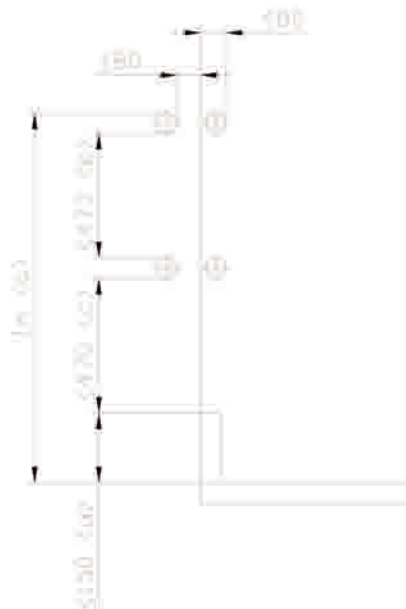
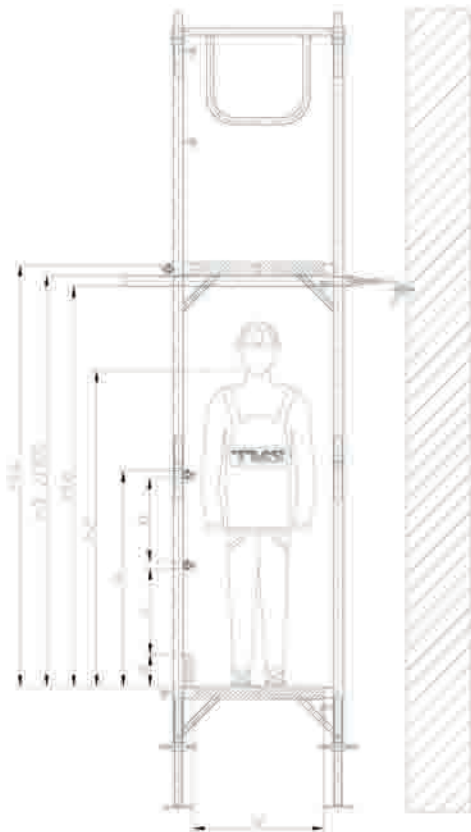

Figure 3 - Dimensions for vertical side protection with one intermediate guardrail

Scaffold EN 12810 -- 3N -- SW06/250 -- H2 -- A -- LA

Service load class: 2kN/m², Load Class (3)

drop tests on platform: without drop test (N)

System width class: w=75cm, bay L=250cm, (SW06)

Headroom class: h1=193cm, h2=175,8cm, (H2)

(A) without cladding; (B) with cladding see Table 1 (LA) with ladder; (ST) stairs or (LS) both: see Table 1

The Scaffold to be of load class 3, system width at least 0,6 m and less than 0,9 m bay length 2,5 m, headroom between working areas and transom or tie member > 1,90 m, with cladding, with ladder access.

STANDARD FRAME



STARTER FRAME

PEDESTRIAN ACCESS FRAME



ITEM	ITEM NO	WEIGHT
SF-A 75	010 021 00610	18,70 kg
SF-A 75 Y	010 021 00611	13,70 kg
SF-A 100	010 021 00620	19,65 kg
SF-A 100 Y	010 021 00621	14,65 kg
SF-A	010 021 00630	26,80 kg

HORIZONTAL LEDGER

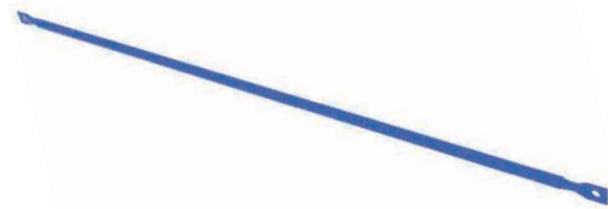

ITEM	ITEM NO	WEIGHT
SF-Y 125	010 021 00640	2,07 kg
SF-Y 150	010 021 00642	2,45 kg
SF-Y 200	010 021 00644	3,25 kg
SF-Y 250	010 021 00646	4,05 kg
SF-Y 300	010 021 00648	4,84 kg

DIAGONAL BRACING

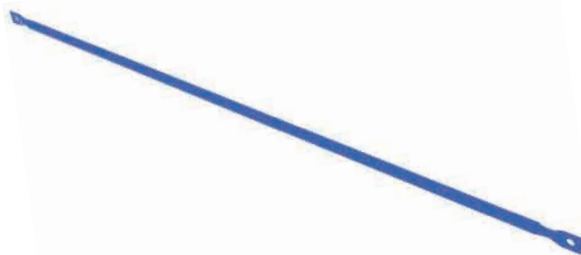

ITEM	ITEM NO	WEIGHT
SF-C 125	010 021 00650	3,80 kg
SF-C 150	010 021 00652	4,03 kg
SF-C 200	010 021 00654	4,55 kg
SF-C 250	010 021 00656	5,15 kg
SF-C 300	010 021 00658	5,78 kg

HOOK TYPE TIE EQUIPMENT



PARAPET-TIE EQUIPMENT

COMPRESSION EQUIPMENT (SPACER) 25 cm



ITEM	ITEM NO	WEIGHT
SF-B 75	010 021 00665	3,95 kg
SF-B 100	010 021 00667	4,65 kg
IS-B	010 021 00132	3,70 kg
KB-D	010 017 01670	2,05 kg

SCAFFOLDING FIXING TUBE

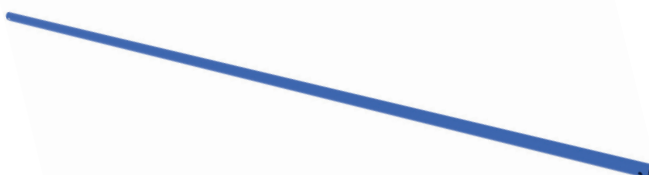

ITEM	ITEM NO	WEIGHT
BR-U	002 012 04832	3,55 kg/mt

SCAFFAST®

NARROW SIDE GUARDRAIL



TOEBOARD FRAME CONNECTOR

ITEM	ITEM NO	WEIGHT
SF-K 75	010 021 00675	4,10 kg
SF-K 100	010 021 00677	4,90 kg
SF-T	010 021 00679	0,18 kg

ADJUSTABLE BASE SPINDLE



SWIVEL COUPLER



RIGHT ANGLE COUPLER

ITEM	ITEM NO	WEIGHT
AA-M Ø35x500	010 012 00505	4,30 kg
BK-D 1,5x1,5 S	004 121 01516	1,05 kg
BK-D 1,5x1,5D	004 121 01515	1,05 kg

STEEL PLATFORM



ACCESS DECK w/ LADDER

ITEM	ITEM NO	WEIGHT
KL-P 312	010 020 13112	11,00 kg
KL-P 315	010 020 13115	12,30 kg
KL-P 320	010 020 13120	15,20 kg
KL-P 325	010 020 13125	18,35 kg
KL-P 330	010 020 13130	21,50 kg
MP-P 625	010 020 16025	39,00 kg

FACADE SCAFFOLD STAIR



OUTER STAIR GUARD

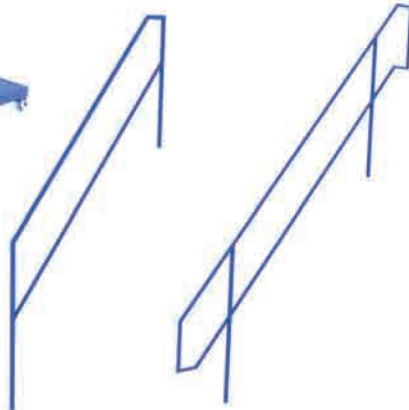

INNER STAIR GUARD

ITEM	ITEM NO	WEIGHT
SF-M	010 021 00260	62,20 kg
MI-K	010 021 00265	8,75 kg
MD-K	010 021 00270	13,50 kg

